



Toshiba Satellite 2430-S255 Optical Disc Drive Replacement

A simple guide to replace the Optical Disc Drive (CD/DVD Drive) in a Toshiba Satellite 2430-S255. This guide precedes the Hard Drive replacement guide.

Written By: Stefan Bruendl



This document was generated on 2020-11-28 06:39:55 AM (MST).

INTRODUCTION

A simple guide to replace the Optical Disc Drive (CD/DVD Drive) in a Toshiba Satellite 2430-S255. This guide precedes the Hard Drive replacement guide.

To make sure the hard drive is not properly working and is in need of replacement, refer to be [this troubleshooting guide](#)

Step 1 — Battery



- Locate the battery locking mechanism on the back side of the laptop. It is labeled with a lock and unlock symbol to indicate its function. The mechanism also has a serrated texture to increase grip.

Step 2

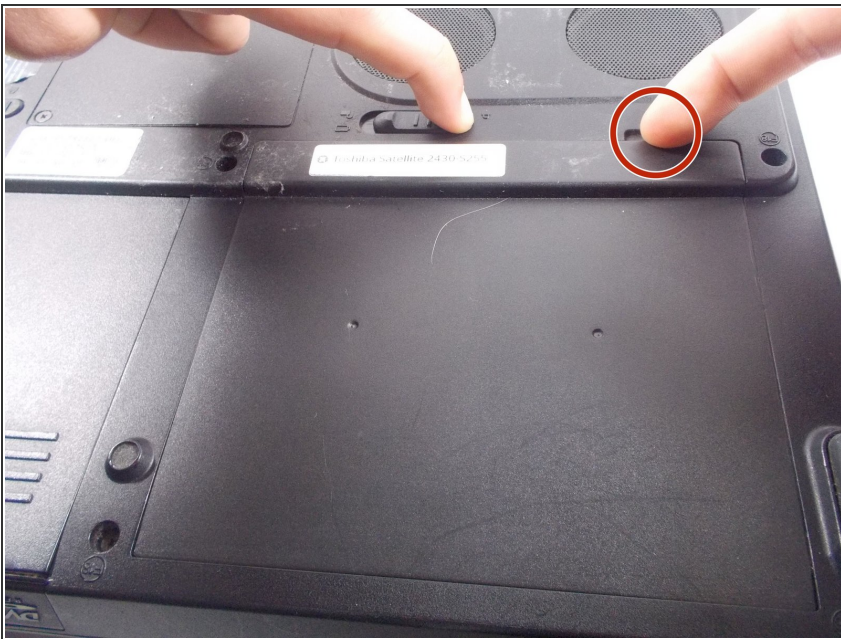

- Place your left hand on the locking mechanism and slide it all the way to the left. This will move it into the unlocked position. While holding the mechanism in the unlocked position place another finger in the cavity to the right of the locking mechanism.

Step 3



- Pulling up with your right hand while the locking mechanism in the unlocked position will release the battery from its socket.

Step 4 — Optical Disc Drive



- Flip your device on its backside.
- Slide the latch on the bottom left of the backside all the way to the left
- Keep holding the latch in that position and move to the next step.

Step 5



- While holding the latch in place, pull out the Optical Disc Drive towards your body, away from the latch with another hand.
- ⓘ The Drive should move smoothly. If it is not movable, the latch may not be pushed all the way to the left.
- ⓘ The Drive has friction grids to make pulling it away from the latch easier.

To reassemble your device, follow these instructions in reverse order.