



# Autosampler Installation Procedure (For Old Version)

Learn how to reinstall the autosampler by connecting it to the node in the field.

Written By: Brooke Mason



## Step 1 — Preparing before heading into the field



- 1. Ensure the autosampler wire and autosampler battery wire are threaded through the conduit before heading to the field.
- 2. Clean and prepare bottles and tubing prior to heading to the field.
- 3. Charge and check battery levels of a node battery and an autosampler battery prior to heading to the field. See this [tutorial](#) for more details.

⚠ Go through the autosampler field [installation checklist](#) to ensure you have all the tools before heading into the field!

## Step 2 — rewiring the node

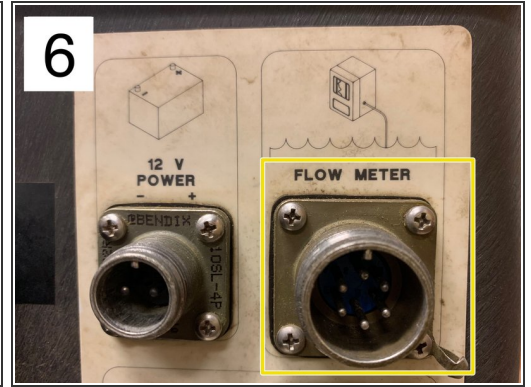
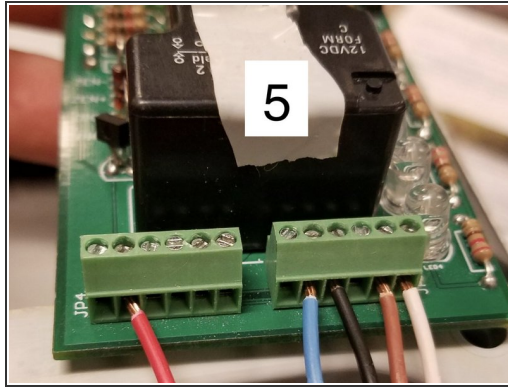
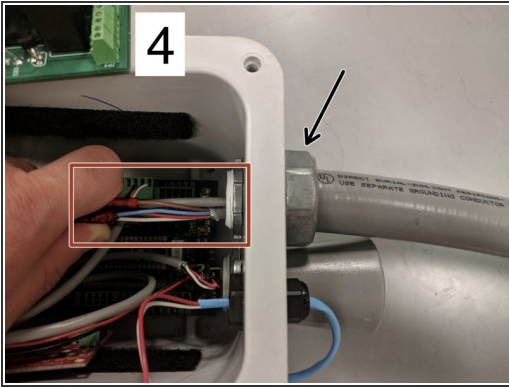

- 4. Connect conduit to the node.
- 5. Rewire the node. See this [tutorial](#) for more detail.
- ⚠ Confirm no exposed wires are touching or else you could short the circuit!
- 6. Reconnect the 6-pin autosampler connector.

## Step 3 — connecting all the components

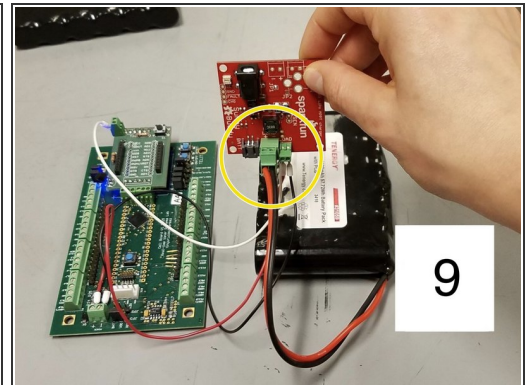
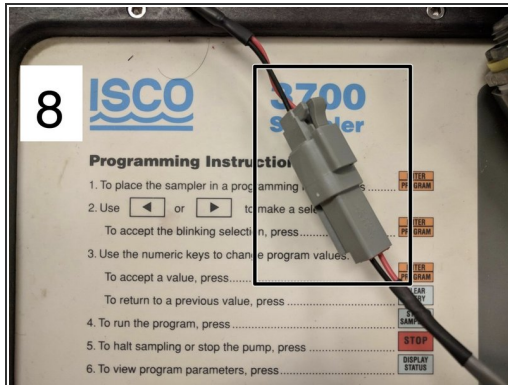
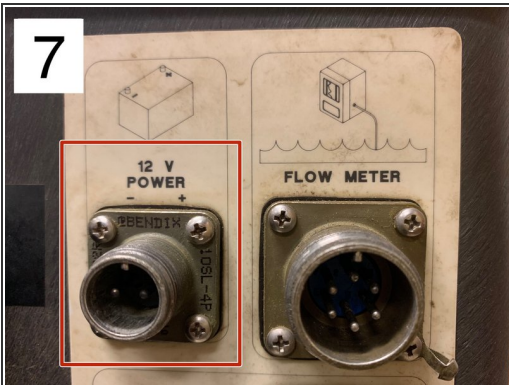

- 7. Reconnect the 2-pin autosampler battery to the autosampler.
- 8. Reconnect the grey battery connector from the autosampler to the node.
- 9. Reconnect the lithium ion battery in the node.



## Step 4 — configure and program autosampler

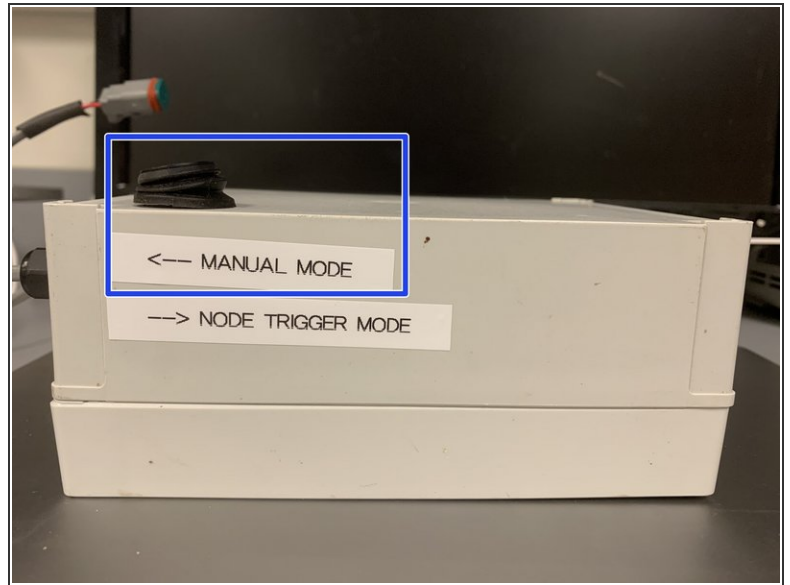
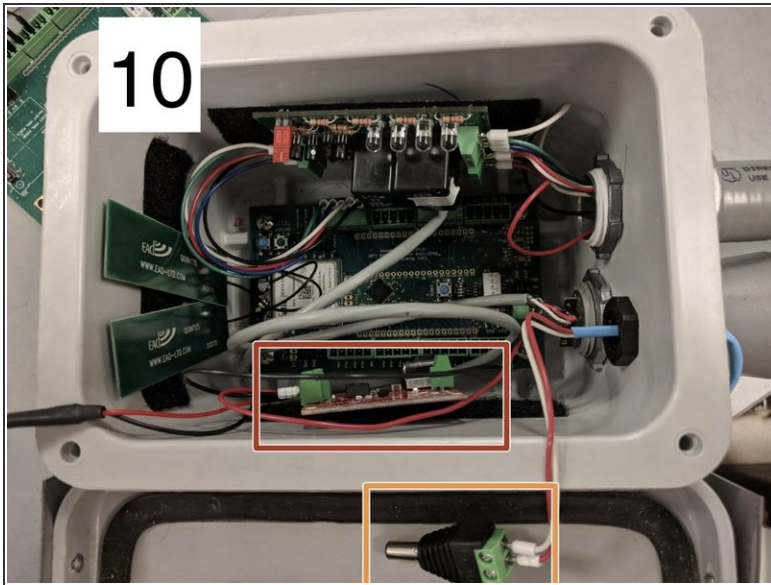

- 10. Secure solar charge controller to the side of the enclosure using velcro.
- Then plug in the solar charger last.
- 11. Flip the autosampler battery switch away from the enclosure edge to turn it on. Confirm the autosampler is correctly configured. See this [tutorial](#) for configuring. Confirm the autosampler is correctly programmed. See this [tutorial](#) for programming.

## Step 5 — setting sample bottle number

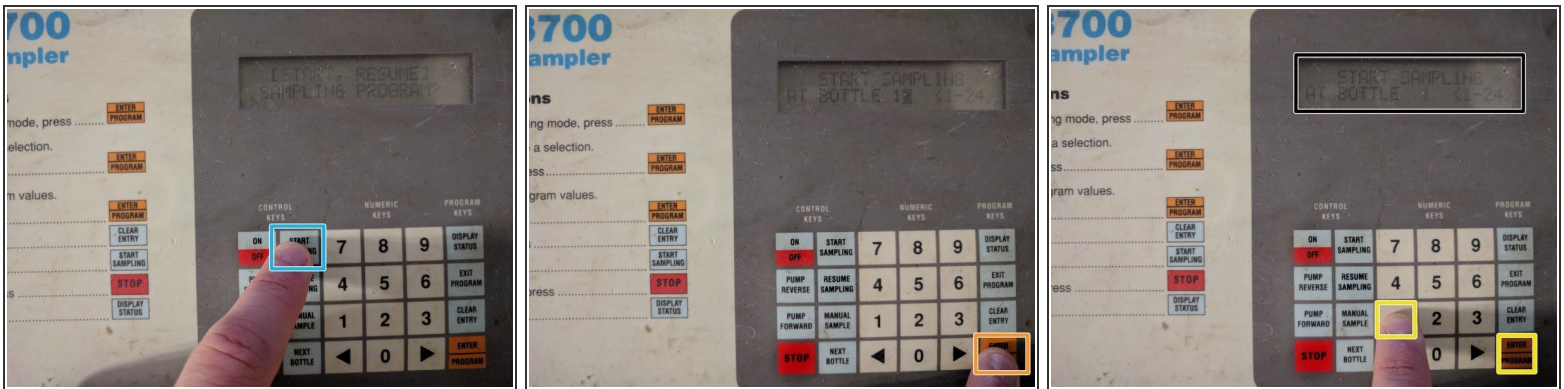

- Press Start Sampling
- Press Enter
- Press the number of the bottle you want to sample on and then Press Enter

## Step 6 — put autosampler in "node trigger mode"

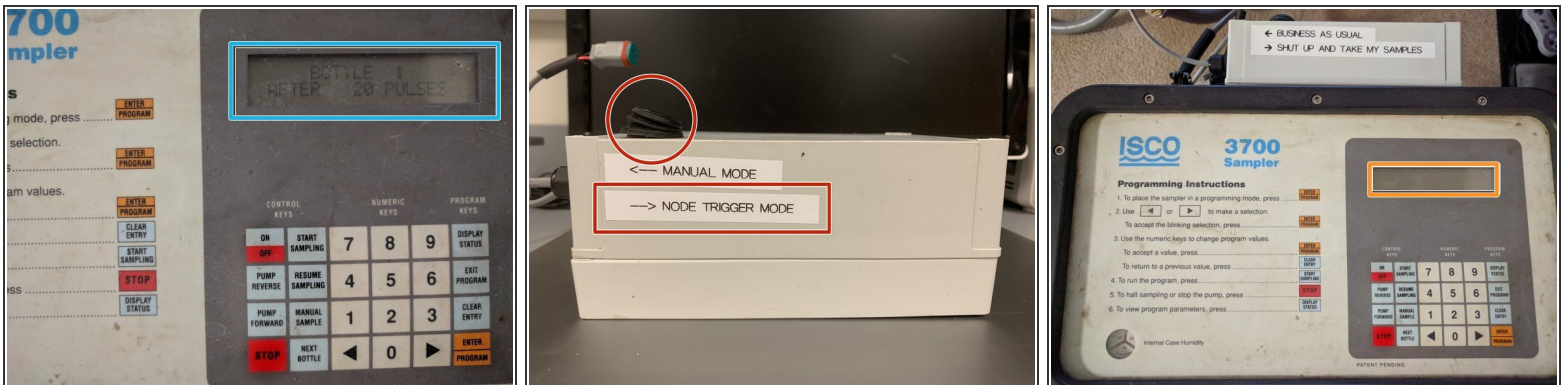

- LCD should now show which bottle it will take a sample in
  - To enable autonomous mode, flip switch to "Node Trigger Mode"
  - LCD should turn off
- ⚠ If the autosampler is to be remotely triggered, avoid using the ON/OFF button to power off the sampler.



## Step 7 — trigger the sampler

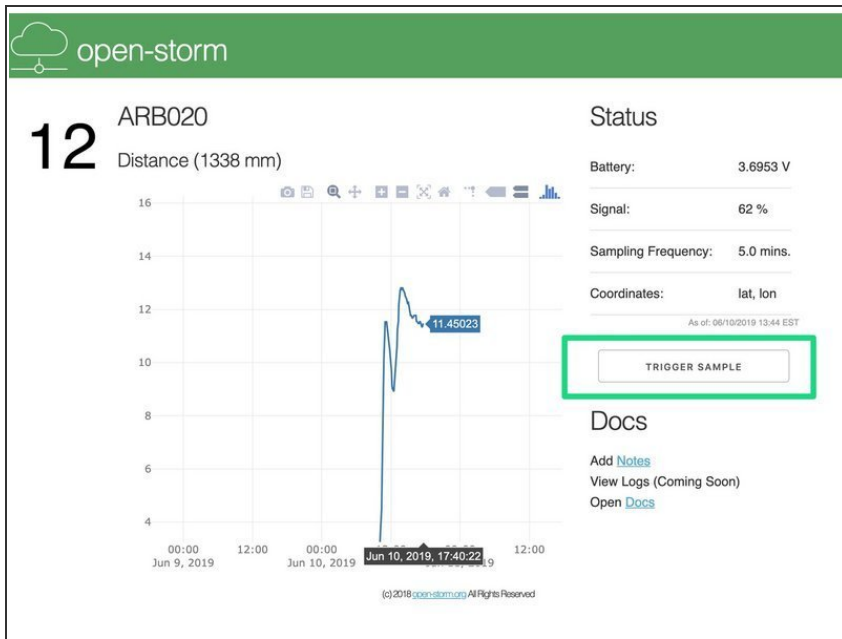

- Trigger a sample on the appropriate site website.
- ❗ If you see N/A on the status for a node this means our server is down. Contact the lab to reset the server! There is a variable called `sleeptimer\_mode`, that will need set to "manual" instead of "auto".

## Step 8 — connect tubing

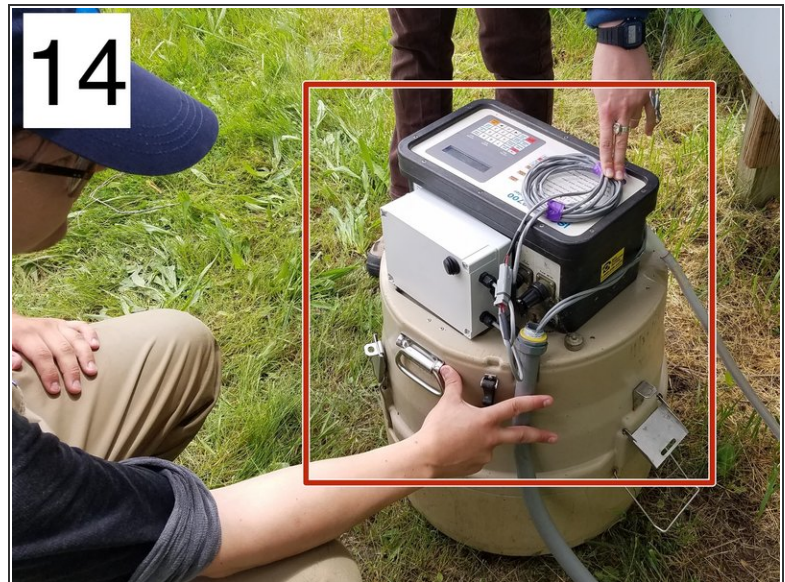

- 13. Once the autosampler triggers correctly, connect the autosampler tubing to the the autosampler with a barb connector. Place the autosampler tubing into the water.
- 14. Secure the wiring on the autosampler.

## Step 9 — secure the autosampler



- 15. Place the autosampler lid back the autosampler.
- 16. Secure the autosampler.
- 17. This is what a completed site looks like.