

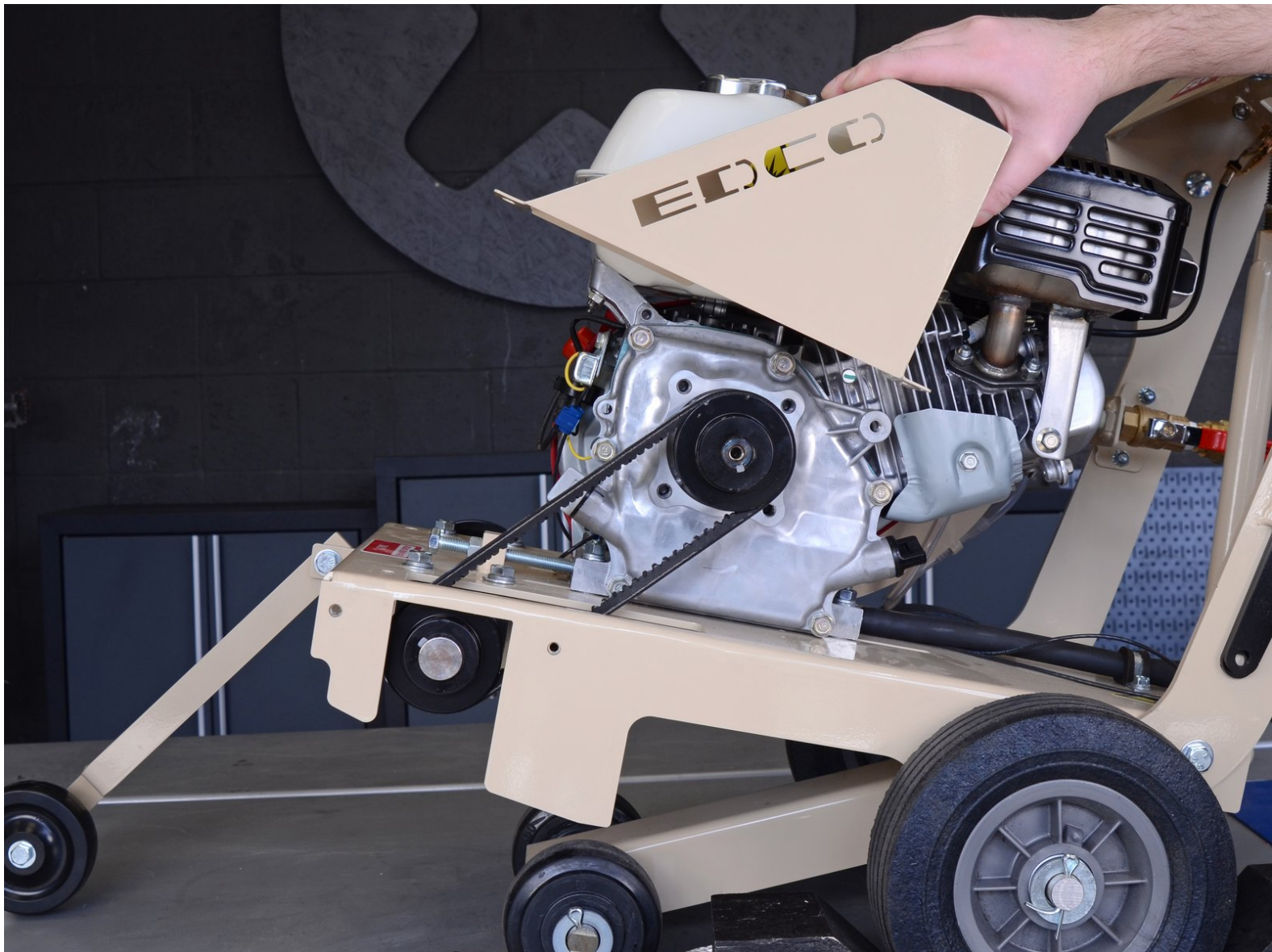

Edco KL14 Belt Guard Replacement

Remove the belt guard on the Edco Cement Saw KL1465H.

Written By: Craig Lloyd



INTRODUCTION

Follow this guide to remove the belt guard on the Edco Cement Saw KL1465H. This procedure is required to remove the belts, as well as the arbor assembly.

TOOLS:

- [Wheel Chocks](#) (1)
 - [3/8" Wrench](#) (1)
-

Step 1 — Disengage the Spark Plug

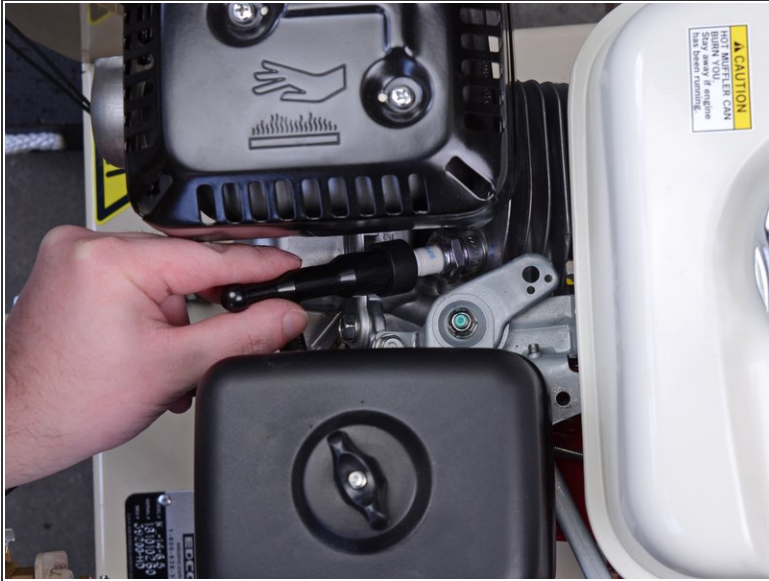

 Before you begin, ensure that the machine is powered down and cool to the touch.

- Disconnect the spark plug to prevent the engine from accidentally starting up during service:
 - Grab the plastic spark plug cap at the end of the spark plug wire.
 - Firmly pull to disconnect the spark plug cap from the spark plug.

Step 2 — Place Wheel Chocks

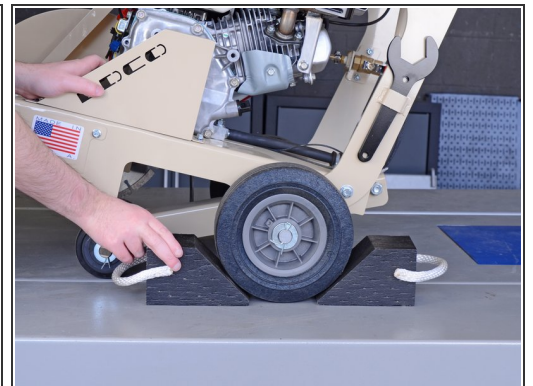

- To prevent the concrete saw from rolling during service, place wheel chocks in front of and behind a rear wheel.

Step 3 — Remove the Arbor Guard

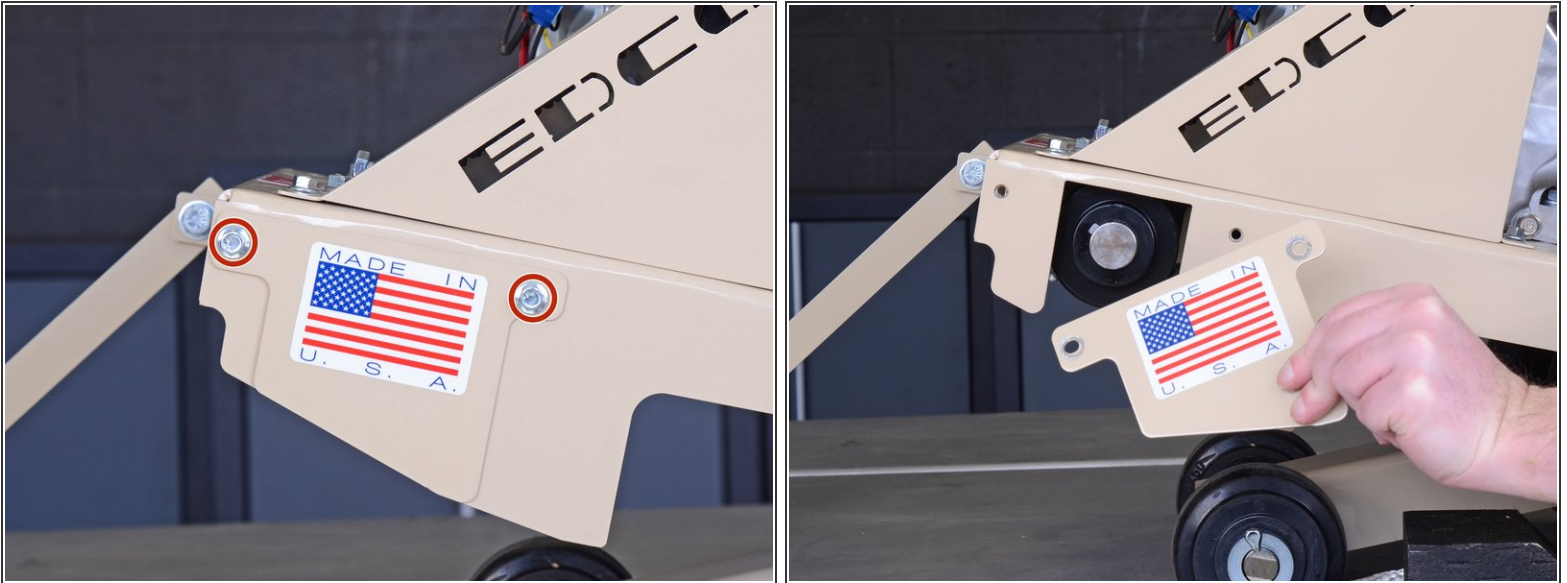

- Use a 3/8-inch wrench to remove the two bolts securing the arbor guard.
- Remove the arbor guard.

Step 4 — Remove the Belt Guard

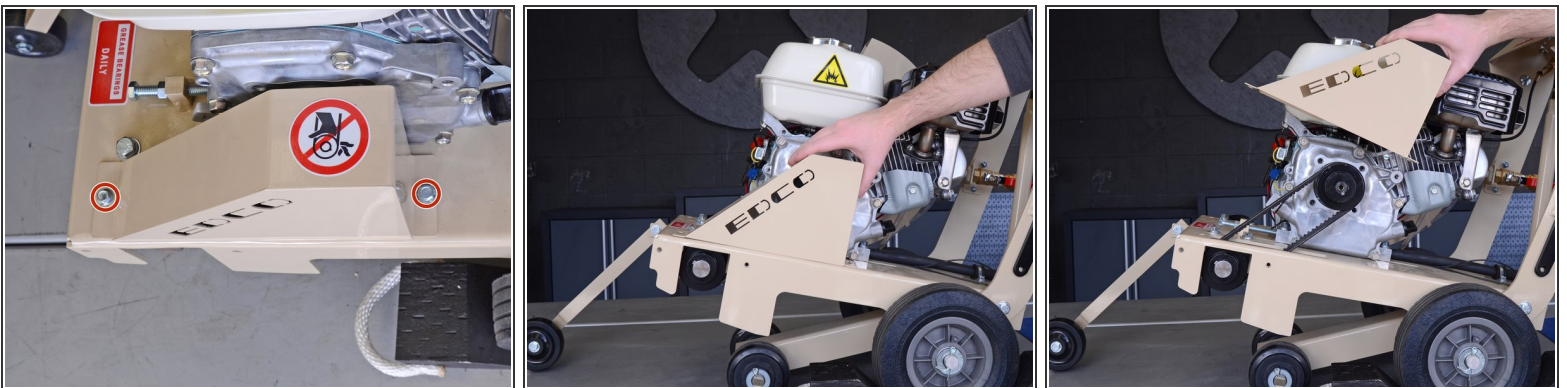

- Use a 3/8-inch wrench to remove the two bolts securing the belt guard.
- Remove the belt guard.

To reassemble your device, follow these instructions in reverse order.