



Node Swap

Swap out a sensor node

Written By: Travis Dantzer





TOOLS:

- [9/16" socket wrench](#) (1)
-

Step 1 — Loosen front tapcon



- the standard concrete drilled node
- If your node is clamped or pole mounted skip to step 3

Step 2 — loosen back tapcon and swivel node toward you



- with the front tapcon removed you should be able to swing the node back toward the concrete surface it's mounted on
- you'll likely need to loosen the back tapcon and pull up on the cantilever for the node to pivot freely

Step 3 — remove old node

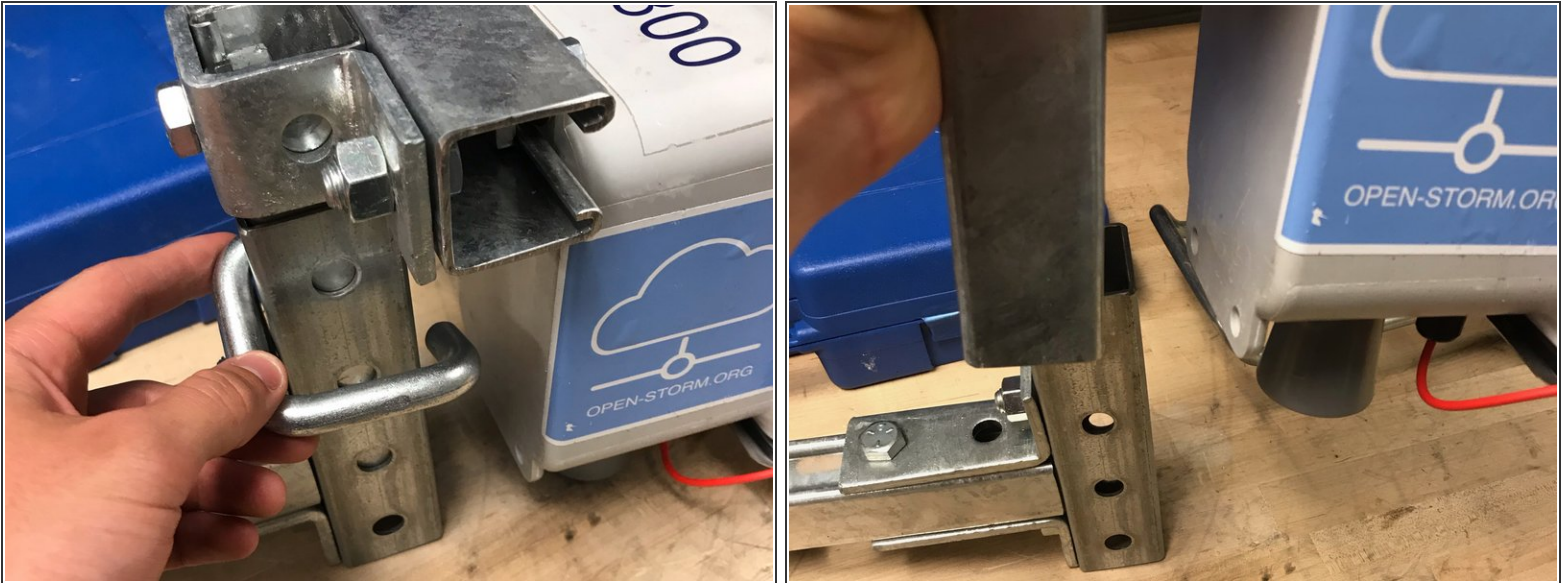

- first, note if the pin is weight bearing. if so make sure to support the node while you remove the pin (or lock)
- pull old node out

Step 4 — replace with new node and measure



- after sliding a new node in and replacing the pin or lock, measure the distance from the bottom of the ultrasonic depth sensor cone to the top of the cantilever beam. you may find a spare piece of strut to help with this.
- you should do this before reattaching the front tapcon or clamp

Step 5



- Using a (weighted) tape measure, measure and record the distance from the bottom of the depth sensor node to the bottom of the river.
- The bottom of the depth sensor node is defined as the bottom of the sensor cone.

Step 6 — return node to full extent



- if node is drilled into concrete swivel the cantilever back to its full extent and reattach the front tapcon
- if the node is clamped, reclamp the node at its full extent
- for a pole-mounted node, you should be able to swap without altering the structure at all

