



Trek 4300 Bicycle Brakes Replacement

This guide outlines how to replace the brakes.

Written By: Emily OConnor



INTRODUCTION

The trek bike uses caliper breaks. When the grooves of the breaks disappear it means it is time to replace the brakes. Once replaced the brakes will need to be realigned so that the pads contact only the rim of the bike.



TOOLS:

- [H5 Hex adapter](#) (1)
 - [T shaped handle socket screwdriver](#) (1)
-

Step 1 — Loosening the Brake Pads

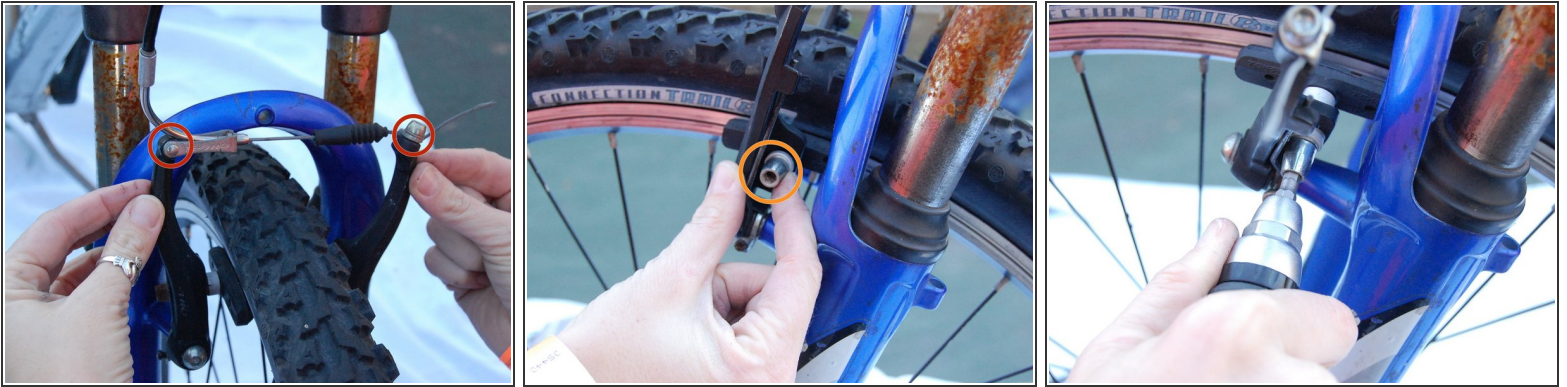

- Position the bike so you are facing the braking mechanism of the front wheel.
- Locate the brake calipers. Push the calipers together to relieve the brake tension. Unhook the brake wire from the metal tube in your left hand.
- Locate the brake pad.
- Using a socket screwdriver with a hex adapter, loosen the nut holding the brake pad in place.
- Repeat for both brake pads.

Step 2 — Removing the Brake Pads

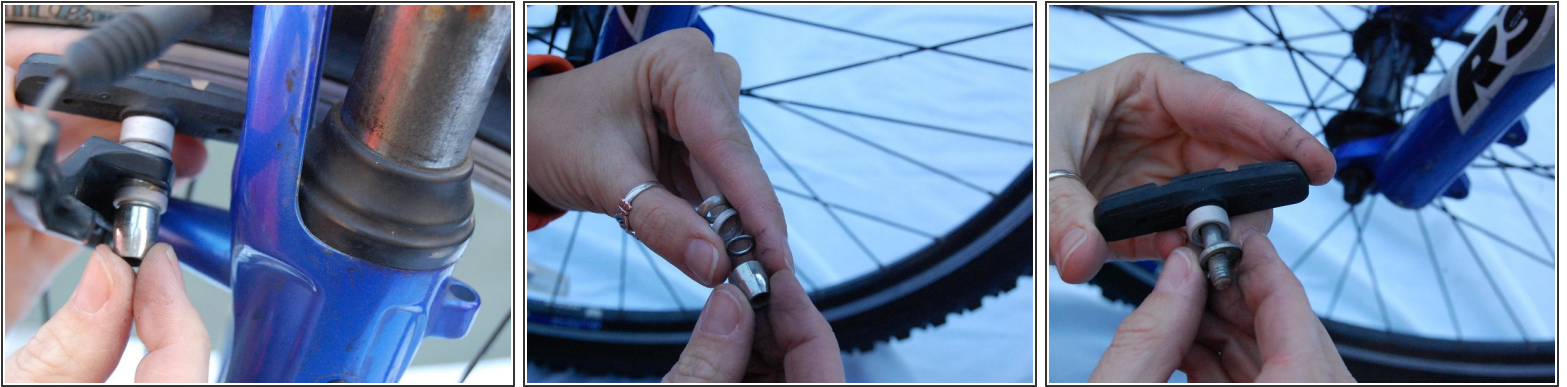

- Next, take the nut completely off of the bolt.
 - ❗ There are 5 washers per brake pad so be sure not to misplace any.
 - ★ It helps to place the nut and washers in order to make reassembly easier.
- Remove the three washers in between the nut and caliper. These will be referred to as the outside washers.
- Next remove the brake pad from the caliper and remove the two washers sitting in between the caliper and the brake pad. These will be referred to as the inside washers.

Step 3 — Replacing New Brake Pad



- Take your new brake pad and place the two inside washers on the bolt and slide them all the way to the pad. The one closest to the caliper should have one rounded edge that faces away from the caliper surface.
- Feed the bolt through the elongated hole on the caliper with the brake facing toward the centerline of the bike.
- Next feed the outside washers onto the bolt. The rounded washer should be placed first with the rounded edge away from the caliper.
- Finally screw the nut onto the end of the bolt and tighten the nut enough to stay on but still allowing the brake pad to slide up and down in the oval shaped hole in the caliper.
- Repeat these procedures for both sides.

Step 4 — Adjusting the Brake Pads



- Make sure the top of the pad is facing up.
 - ☒ The brake pad should have a subtle curve and should be aligned so that the curve of the brake pad matches the curve of the wheel.
- Slide the brake pad to the correct height in the caliper so that the pad is making contact only with the rim of the bike.
- Holding the brake pad in place with one hand, tighten the bolt until snug. This should not require a great amount of force, but you should not be able to wiggle the brake pad after tightening.
- Repeat these procedures for both sides.

It is important to take time to properly align your brake pads because failure to do so could cause the brakes to fail and/or the tire to be damaged.